



# Dodge Ram/Dakota Alloy Fuel INSTALLATION INSTRUCTIONS

## ALLOY FUEL DOOR™

APPLICABLE MODELS:  
RAM 96-01 & Dakota 96-02

### PACKAGE CONTENTS

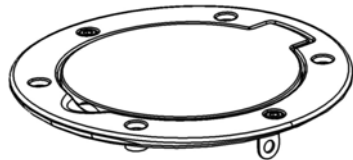

FUEL DOOR ASSEMBLY  
(QTY. 1)



SMALL MOUNTING NUT  
(QTY. 1)



LARGE MOUNTING NUTS  
(QTY. 3)



SPACERS  
(FOR RAM ONLY)  
(QTY. 2)



MOUNTING SCREWS -M5x20  
(QTY. 4)

### TOOLS REQUIRED



4MM HEX DRIVER



T-30 TORX DRIVER

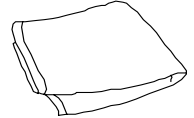

CLEAN CLOTH

## 0 BEFORE INSTALLATION

- 1) READ ENTIRE INSTRUCTIONS BEFORE PROCEEDING.
- 2) CLEAN INSTALLATION AREA.
- 3) HAVE ALL TOOLS AT HAND.

## 1 REMOVE STOCK FUEL DOOR

REMOVE TWO RUBBER STOPS. CAREFULLY REMOVE GAS CAP TETHER FROM FUEL DOOR HINGE (DO NOT BREAK TETHER). USE T-30 TORX DRIVER TO REMOVE THE TWO HINGE-MOUNTING SCREWS AND CAREFULLY REMOVE STOCK FUEL DOOR.

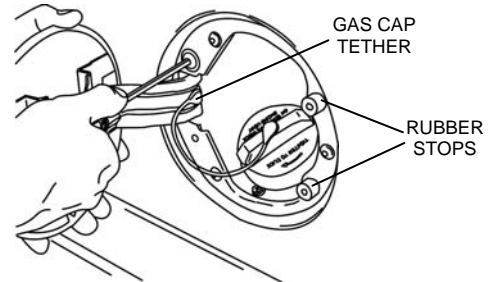

## 2 POSITIONING FUEL DOOR

WITH ALL FOUR MOUNTING BOLTS IN THEIR PLACES POSITION ALLOY FUEL DOOR.  
NOTE: FOR RAM TRUCKS TWO SPACERS WILL BE NEEDED BETWEEN FUEL DOOR AND MOUNTING SURFACE AT BOLTS NEAR HINGE.

AFTER POSITIONING, APPLY AND FINGER-TIGHTEN TWO LARGE MOUNTING NUTS TO THE BOLTS NEAREST THE FUEL DOOR HINGE.

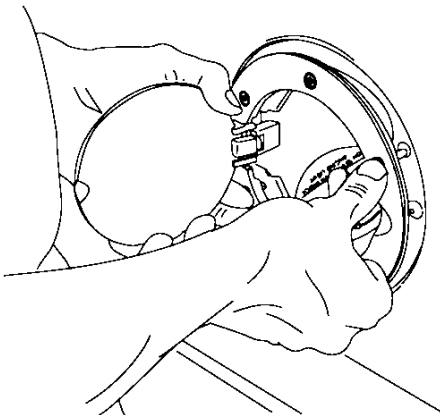

## 3 FASTENING FUEL DOOR

AFTER APPLYING AND FINGER-TIGHTENING TWO LARGE MOUNTING NUTS NEAR HINGE, APPLY AND FINGER-TIGHTEN TWO MOUNTING NUTS OPPOSITE THE HINGE. FIRST APPLY THE LARGE MOUNTING NUT (UPPER OR LOWER: THE RAM WILL BE LIMITED TO ONLY ONE FITTING). THEN APPLY THE SMALLER MOUNTING NUT TO THE REMAINING BOLT. TIGHTEN EACH BOLT WITH 4MM HEX DRIVER. AFFIX GAS CAP TETHER TO BRACKET ON FUEL DOOR RING.

